

## INSTALLATION TIPS

Detailed cabinet assembly instructions come in Box A. If for some reason you are missing an assembly instruction, you can download a copy from our website [www.eurorite.com](http://www.eurorite.com). The following pages will have important information when installing some of our more unique type of cabinets.

Installation screw kits are sold separately. One INS kit can install on average 7 cabinets. Be sure to order enough to complete your installation.

### *BLIND CORNER WALL & BASE CABINETS*

Blind corner cabinets can be used when space is an issue and a traditional angle corner will not fit.

When installing these cabinets here are a few things to remember:

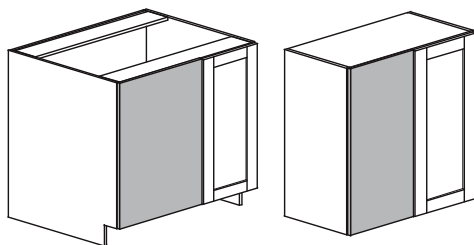

1. You must "pull" the blind cabinet out from the wall far enough to clear the adjacent cabinet, door and hardware. On average that would be 2-4" for blind wall install and 7-9" for blind base install.
2. A filler strip has to be installed between the blind panel and the adjacent cabinet. The filler strip must be greater than the projection of the handle on the adjacent cabinets.
3. A 36" blind wall comes with 2 doors.

