

# ADVANTAGE ONE

READY TO ASSEMBLE  
SOFT CLOSE  
*Bathrooms*



# Standard Vanities

The Standard line is Euro-Rite Cabinets traditional bathroom cabinet line.

Offered in 7 in stock door styles. All items feature soft close doors and drawers and are conveniently packaged complete in one box.



Combination examples:





# Standard Vanity Cabinet Details

**24" w VANITY**  
32 1/4" H X 20 5/8" D

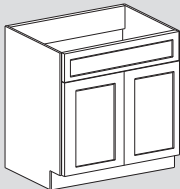

V2421 - 24" wide

**30" w VANITY**  
32 1/4" H X 20 5/8" D

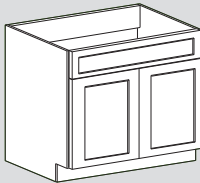

V3021 - 30" wide

**30" w COMBO**  
32 1/4" H X 20 5/8" D

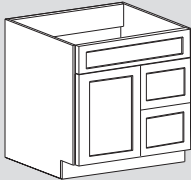

VD3021-2 - 30" wide

**36" w COMBO**  
32 1/4" H X 20 5/8" D

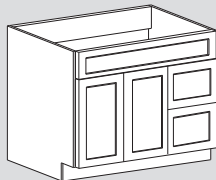

VD3621-2 - 36" wide

**48" w COMBO**  
32 1/4" H X 20 5/8" D

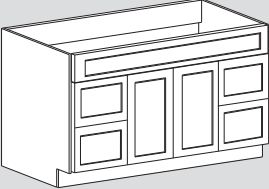

VD4821-4 - 48" wide

**12" w DRAWER**  
32 1/4" H X 20 5/8" D

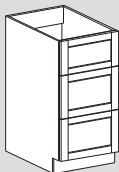

VDB-1221 - 12" wide

**15" w DRAWER**  
32 1/4" H X 20 5/8" D

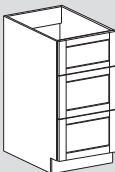

VDB-1521 - 15" wide

**2 DOOR WALL**  
31 7/8" H X 8 5/8" D

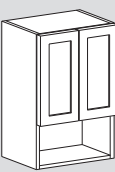

VWALL20 - 20" wide

**MAKE-UP DRAWER**  
5" H X 20" D

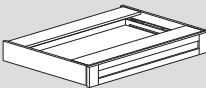

PD - 30" wide

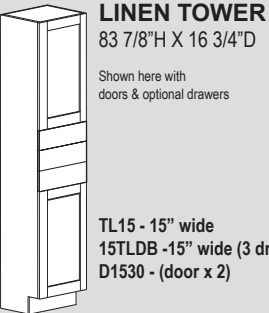

**LINEN TOWER**  
83 7/8" H X 16 3/4" D

Shown here with  
doors & optional drawers

TL15 - 15" wide  
15TLDB - 15" wide (3 drawer)  
D1530 - (door x 2)

## Door Styles

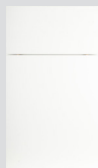

PACIFIC WHITE  
(PFW)



SAN JUAN WHITE  
(R)

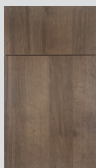

SONOMA KNIGHT  
(SNK)



WHISTLER WHITE  
(WHW)



WHISTLER FOSSIL  
(WHFL)

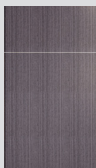

YALETOWN GRAPHITE  
(GR)



SIERRA HOWE  
(SIH)

# ADVANTAGEONE

## *What is AdvantageOne?*

AdvantageOne is Euro-Rite's premiere Canadian quality, ready to assemble cabinet line. We bring over 30 years of precision manufacturing to AdvantageOne. A simple, affordable cabinet program that is easy to understand and trust...all in one box!

## *The Benefits of AdvantageOne:*

- Soft closing doors and drawers are included
- Simple assembly
- Easy handling and transportation
- Extensive warranty
- Made in Canada

## *Our Mission*

Euro-Rite provides the highest quality product; matched only by our dedication to service. We value our customers and work to meet their needs by excelling at service that is prompt and friendly. Our innovative team of employees is important to us, as we strive to create the best of possible working environments. **We Care!**

## KITCHENS



## BATHROOMS



## CLOSETS



**EURO-RITE**  
CABINETS  
*European Styling • Built Right!*

**ADVANTAGEONE**

available at:



Version 0117