

# ADVANTAGEONE

## Assembly Instructions

Instructions D'Assemblée  
Instrucciones de asamblea

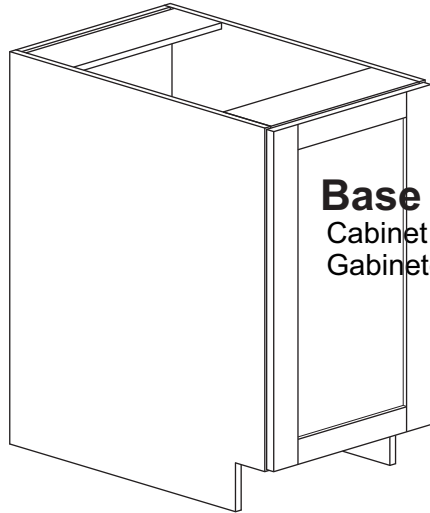

**Base Cabinet - 1 Door**  
Cabinet de base - 1 porte  
Gabinete base - 1 puerta

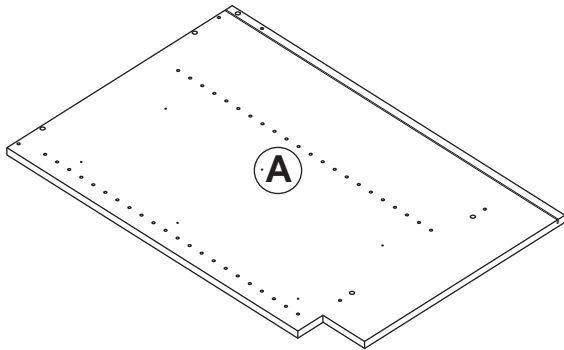
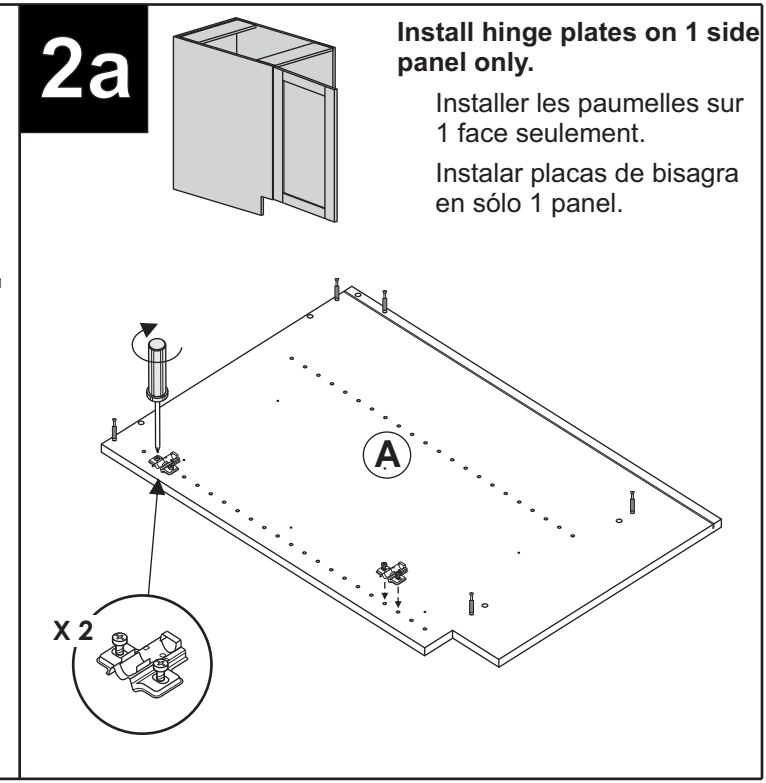
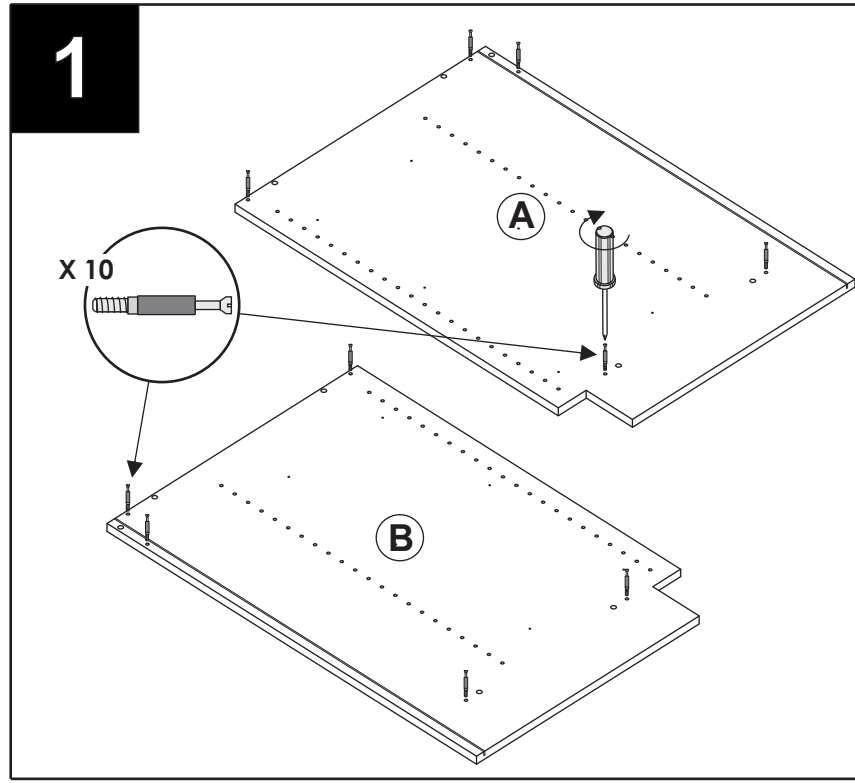

**1 X LEFT HAND GABLE (SIDE PANEL)**  
Pignon de main gauche (panneau latéral)  
Aguilón de la mano izquierda (panel lateral)

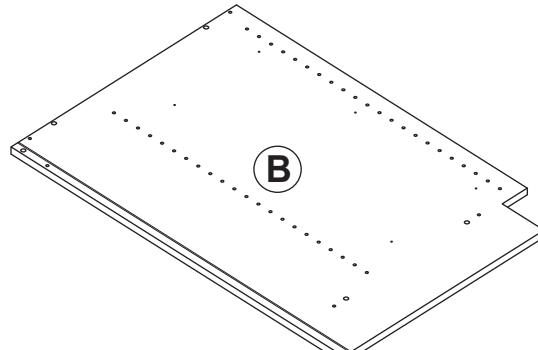

**1 X RIGHT HAND GABLE (SIDE PANEL)**  
Pignon droit (panneau latéral)  
Aguilón derecho (panel lateral)

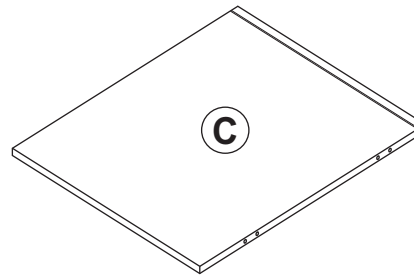

**1 X ASSEMBLY SHELF**  
Étagère d'Assemblée  
Estante de la asamblea

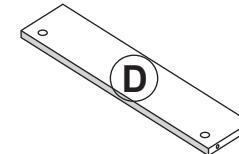

**1 X FRONT RAIL**  
Rail avant  
Carril delantero

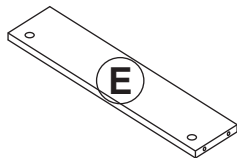

**2 X BACK RAIL**  
Rail arrière  
Carril trasero

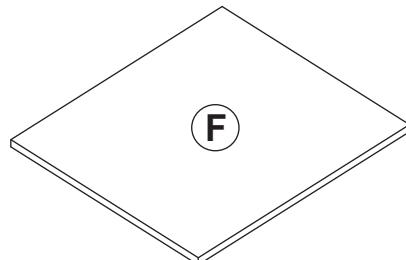

**1 X ADJUSTABLE SHELF**  
Étagère réglable  
Estante ajustable

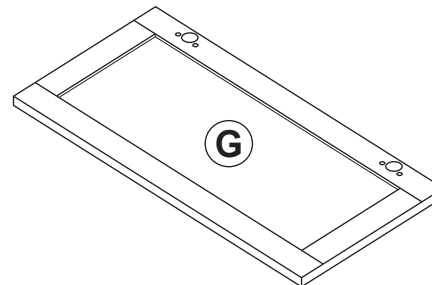

**1 X DOOR PANEL**  
Panneau de porte  
Panel de la puerta

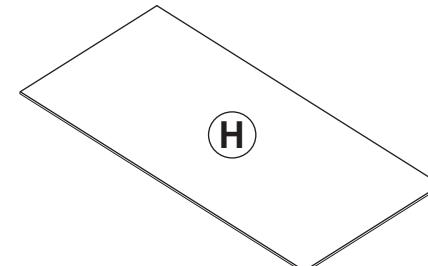

**1 X BACKBOARD**  
Panneau arrière  
Tablero trasero

<b>10 X</b>  0540 0005	<b>2 X</b>  0540 0055
<b>10 X</b>  0540 0025	<b>2 X</b>  0540 0095
<b>10 X</b>  0540 0015	<b>4 X</b>  0550 0005
<b>2 X</b>  0510 0227	<b>2 X</b>  0510 0202

**2b**

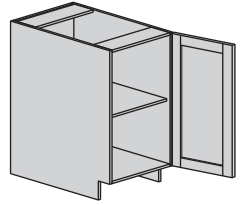

**Install hinge plates on 1 side panel only.**

Installer les paumelles sur 1 face seulement.

Instalar placas de bisagra en sólo 1 panel.

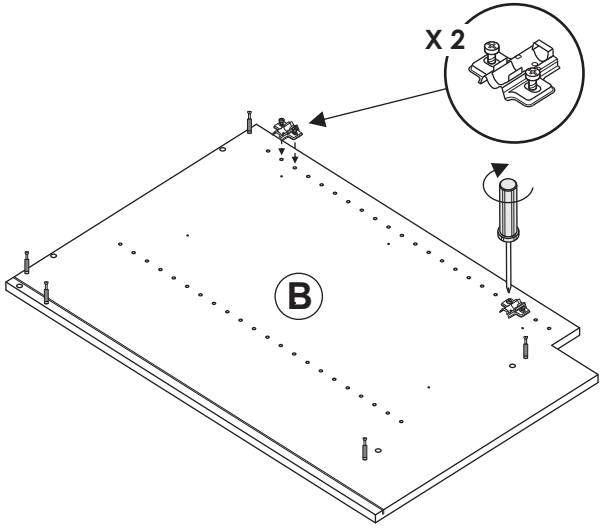
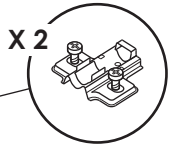

**3**

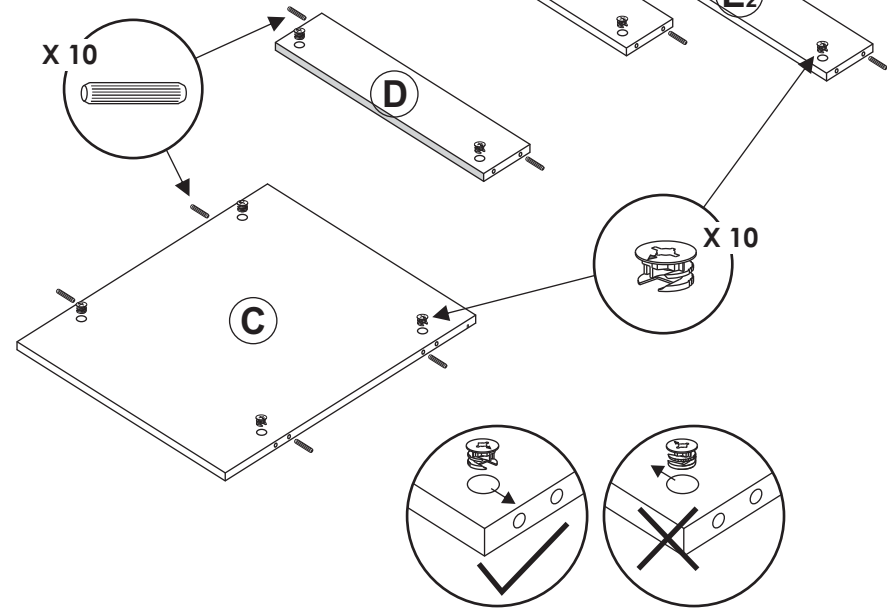
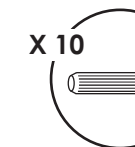

**4**

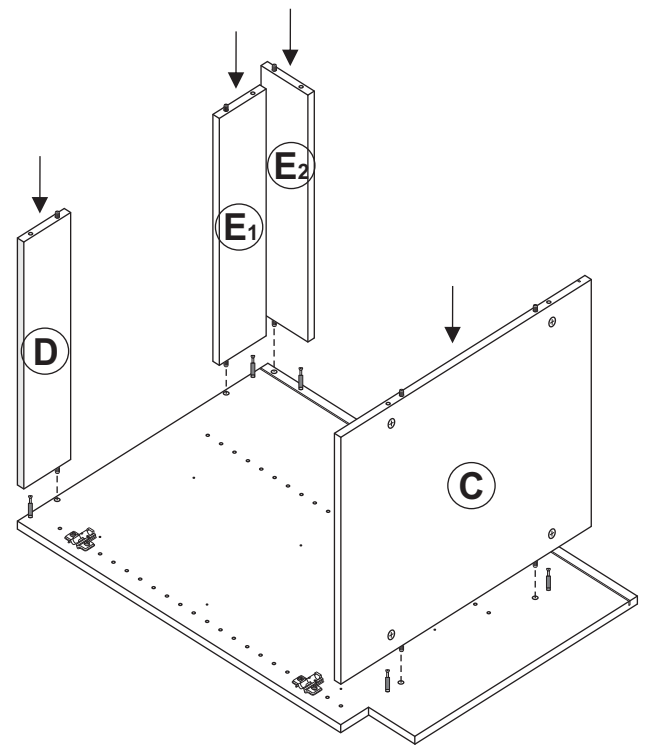

**5**

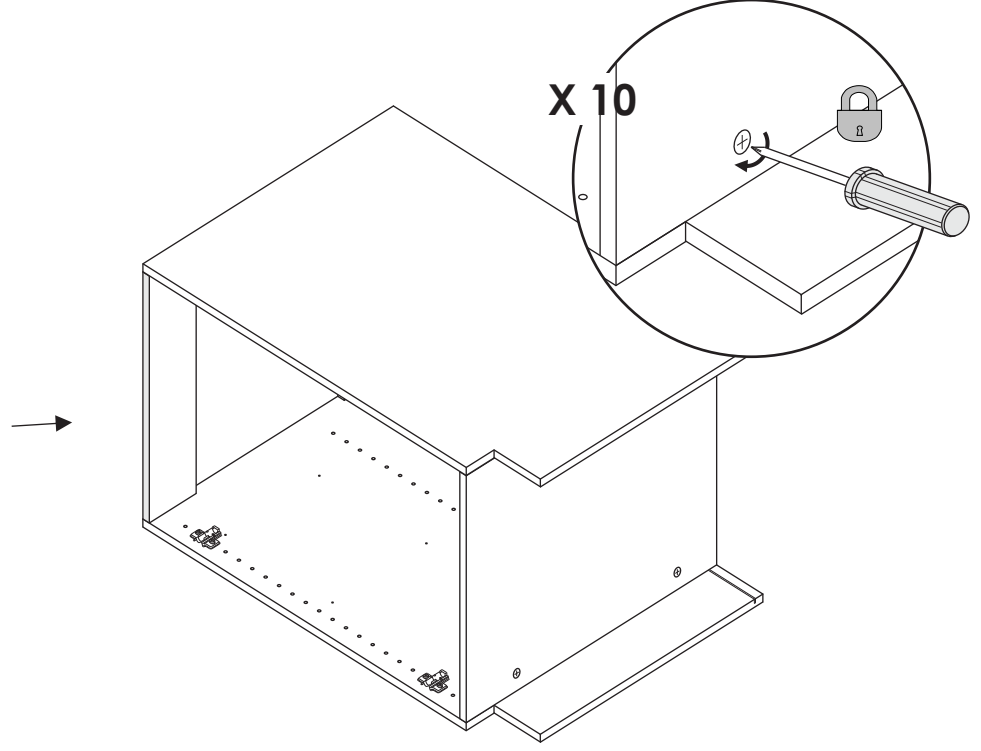
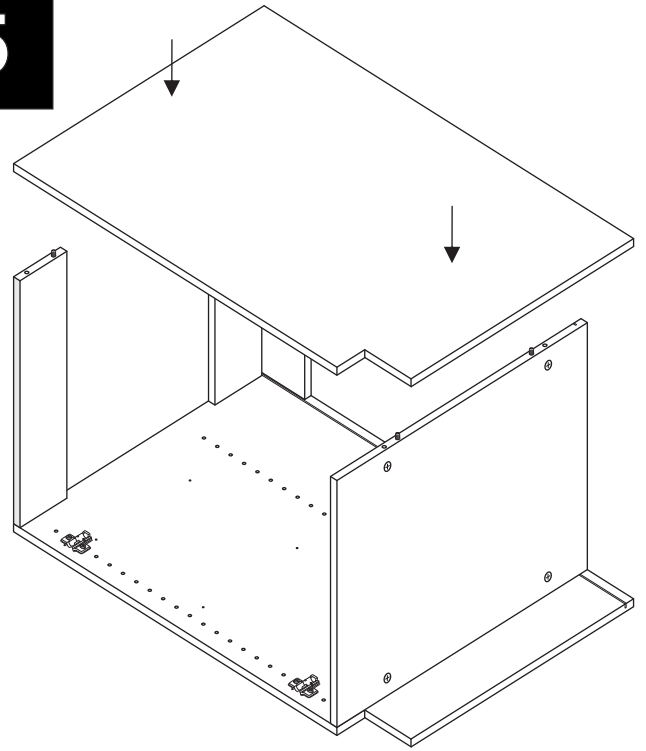

**6**

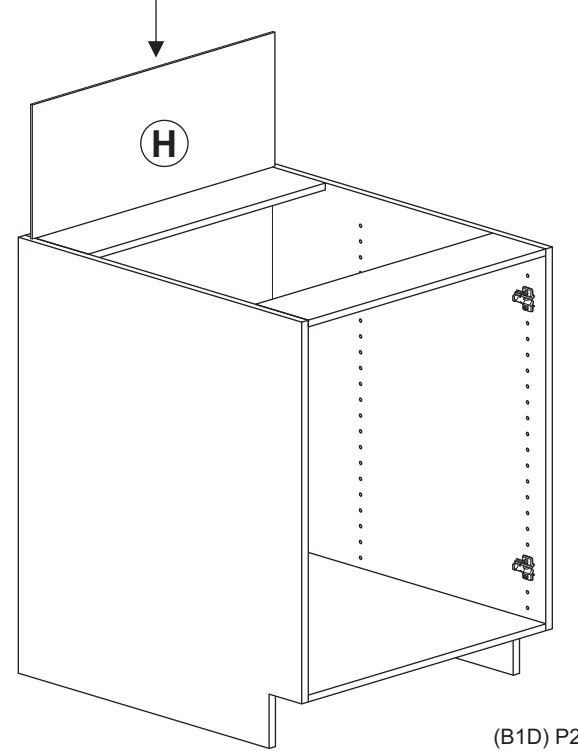

7

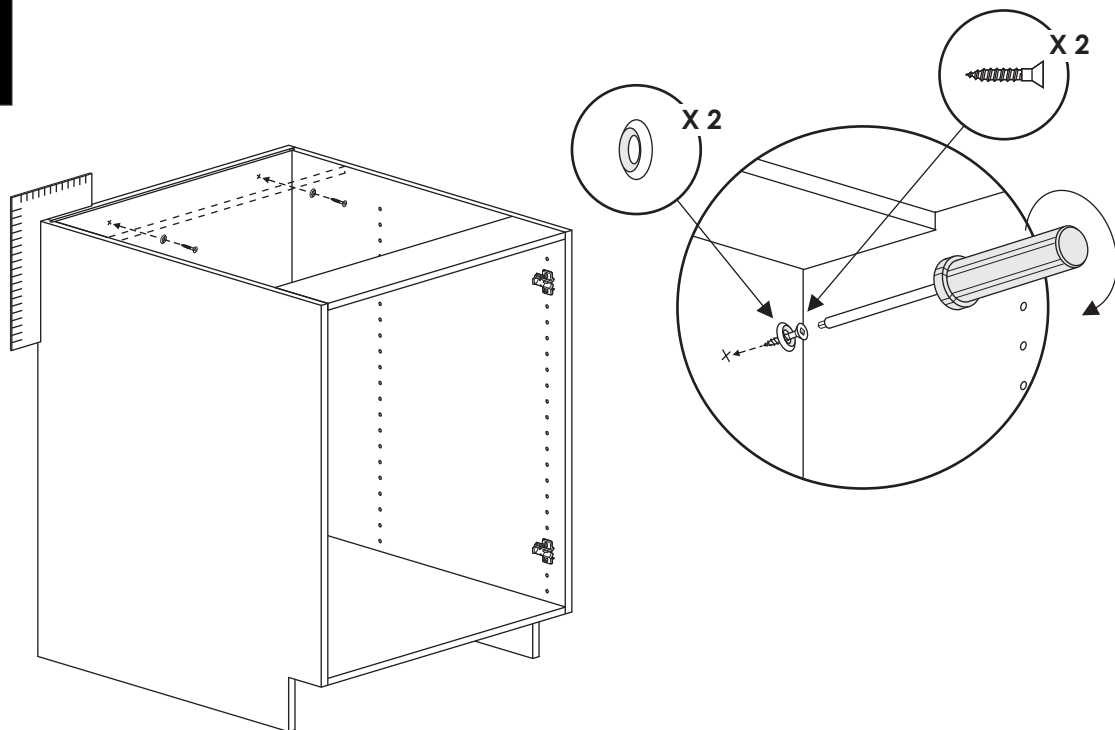

8

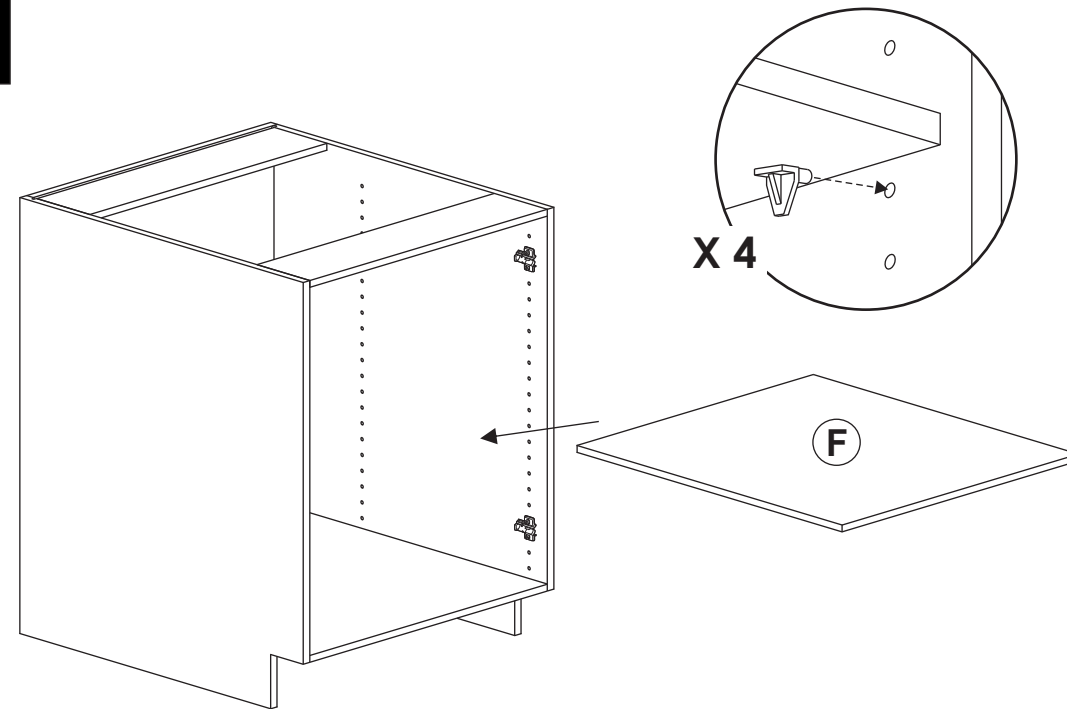

9

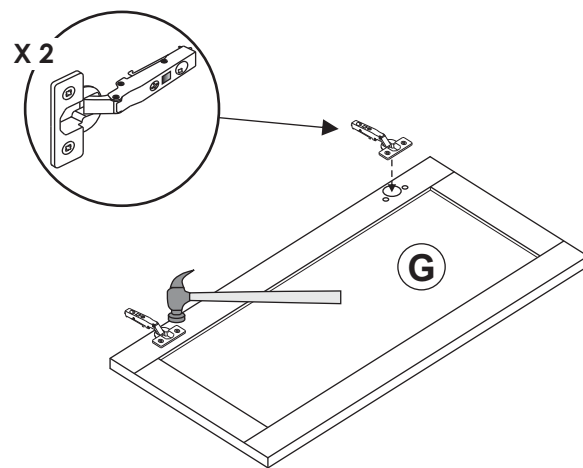

**WARNING:** Place panel on a clean smooth surface to avoid damage to panel front while installing hardware.

ATTENTION : Placer le panneau sur une surface propre et lisse pour éviter des dommages à l'avant du panneau lors de l'installation de matériel.

ADVERTENCIA: Coloque el panel sobre una superficie limpia para evitar daños en el panel frontal durante la instalación de hardware.

10

